

APRON ELEV
381 FT
(116 M)

TOWER: 118.100 MHz
GROUND: 121.800 MHz
APRON: 131.700 MHz

**AIRCRAFT PARKING/DOCKING AND
AERODROME GROUND MOVEMENT CHART- ICAO**

**CHISINAU / LUKK
RWY 08/26**

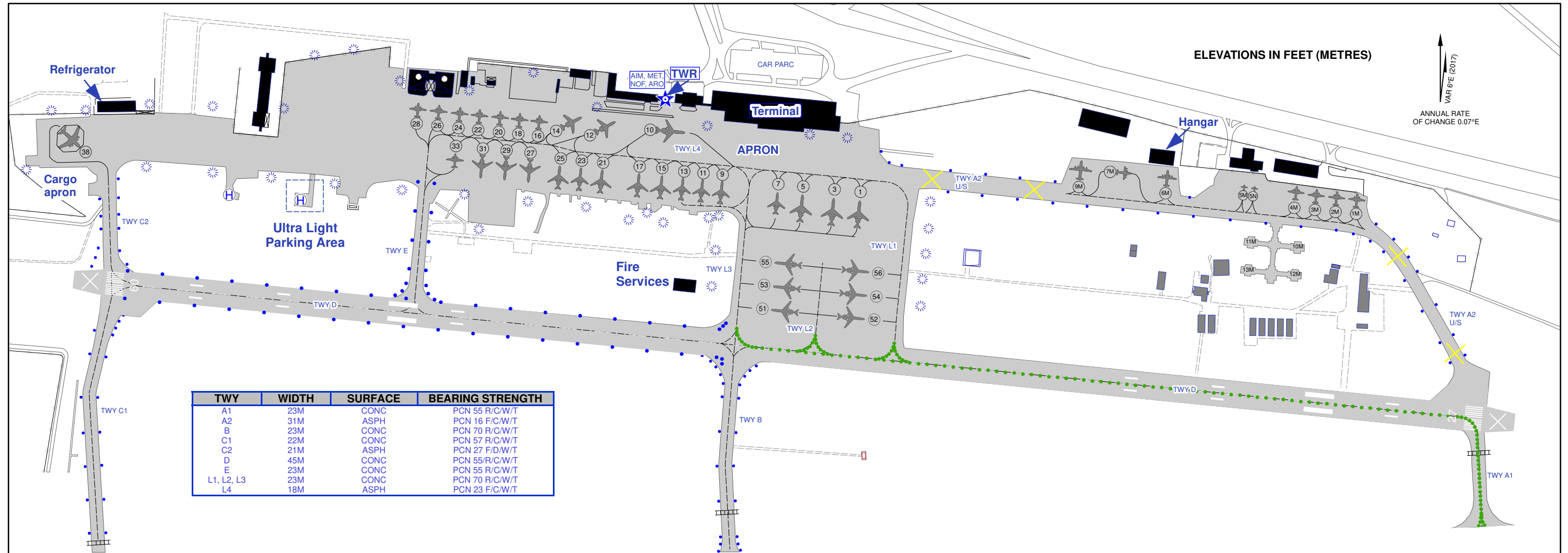

TWY	WIDTH	SURFACE	BEARING STRENGTH
A1	23M	CONC	PCN 55 R/C/W/T
A2	31M	ASPH	PCN 16 F/C/W/T
B	23M	CONC	PCN 70 R/C/W/T
C1	22M	CONC	PCN 57 R/C/W/T
C2	21M	ASPH	PCN 27 F/D/W/T
D	45M	CONC	PCN 55 R/C/W/T
E	23M	CONC	PCN 55 R/C/W/T
L1, L2, L3	23M	CONC	PCN 70 R/C/W/T
L4	18M	ASPH	PCN 23 F/C/W/T

INS REFERENCE POINTS/ACL location and ELEV							PARKING POSITIONS								
PSN	NORTH	EAST	ELEV(FT)	PSN	NORTH	EAST	ELEV(FT)	PSN	NORTH	EAST	ELEV(FT)	Positions	Wingspan max.	Length max.	Remarks
1	46°56'01.23"N	028°56'14.28"E	312	24	46°56'06.96"N	028°55'42.08"E	328	4M	46°56'00.68"N	028°56'49.58"E	298	1	30M	40M	-
3	46°56'01.40"N	028°56'12.17"E	314	25	46°56'03.58"N	028°55'50.03"E	321	5M	46°56'00.95"N	028°56'46.12"E	299	3,5	36M	40M	-
5	46°56'01.64"N	028°56'09.65"E	315	26	46°56'07.12"N	028°55'40.38"E	329	5N	46°56'01.03"N	028°56'45.44"E	299	10	38M	48M	-
7	46°56'01.80"N	028°56'07.63"E	316	27	46°56'02.71"N	028°55'47.43"E	323	6M	46°56'01.61"N	028°56'39.15"E	300	7	29M	37M	-
9	46°56'02.51"N	028°56'03.17"E	316	28	46°56'07.26"N	028°55'38.70"E	330	7M	46°56'02.37"N	028°56'36.35"E	300	9,11,13,23	29M	39M	-
10	46°56'05.25"N	028°56'00.22"E	313	29	46°56'02.87"N	028°55'45.51"E	324	9M	46°56'02.16"N	028°56'32.80"E	301	15,17,21,25	35M	39M	push back
11	46°56'02.64"N	028°56'01.59"E	315	31	46°56'03.01"N	028°55'43.58"E	325	10M	46°55'58.06"N	028°56'49.54"E	298	12,14	35M	37M	push back
12	46°56'05.95"N	028°55'54.60"E	317	33	46°56'04.41"N	028°55'41.59"E	328	11M	46°55'58.34"N	028°56'46.06"E	298	16,18,20,22,24,26,28	29M	27M	push back
13	46°56'02.77"N	028°56'00.01"E	315	38	46°56'05.29"N	028°55'12.32"E	364	12M	46°55'56.53"N	028°56'49.24"E	297	27,29,31	36M	45M	push back
14	46°56'06.25"N	028°55'51.88"E	319	51	46°55'55.30"N	028°56'06.82"E	316	13M	46°55'56.80"N	028°56'45.74"E	298	33	29M	24M	-
15	46°56'02.90"N	028°55'58.30"E	316	52	46°55'54.66"N	028°56'14.41"E	313					38	51M	47M	-
16	46°56'06.41"N	028°55'48.50"E	323	53	46°55'56.60"N	028°56'07.05"E	316					51,52,53,54,55,56	36M	45M	-
17	46°56'03.05"N	028°55'56.44"E	317	54	46°55'55.96"N	028°56'14.65"E	313					1M, 2M, 3M, 4M	28M	24M	push back
18	46°56'06.55"N	028°55'46.92"E	325	55	46°55'57.92"N	028°56'07.18"E	317					5M, 5N	11M	9M	-
20	46°56'06.69"N	028°55'45.35"E	326	56	46°55'57.26"N	028°56'14.89"E	313					6M	32M	28M	push back
21	46°56'03.31"N	028°55'53.47"E	318	1M	46°56'00.18"N	028°56'54.48"E	295					7M	22M	26M	-
22	46°56'06.83"N	028°55'43.67"E	327	2M	46°56'00.32"N	028°56'52.85"E	296					9M	37M	36M	push back
23	46°56'03.44"N	028°55'51.75"E	320	3M	46°56'00.47"N	028°56'51.20"E	297					10M, 11M, 12M, 13M	29M	24M	push back

WARNINGS:

1. Ground taxi operations between parking positions No. 9 and No. 33 for ACFT with wing span more than 30 meters are permitted by towing or accompanied by 'FOLLOW ME' car.
2. Taxiing-in operations to parking positions No. 12 and No. 14 are permitted from the west only.
3. TWY A2 closed for taxiing.
4. The longitudinal slope of parking positions № 1 -1.1%, № 3 -1.8%, № 5 -1.4%, № 9 -1.1%, № 11 -1.1%, № 12 -1.42%, № 14 -1.16%.
5. The cross slope of parking positions № 1 -1.1%, № 5 -1.25%.
6. GND taxi OPS from / to ACFT stands No. 9, 11, 13 for ACFT with wing span up to 25M are allowed only by OPS department clearance (call sign Apron - 131.7 MHz).
7. RWY 09/27 is used as TWY D when RWY 08/26 is active

SCALE 1:7 000

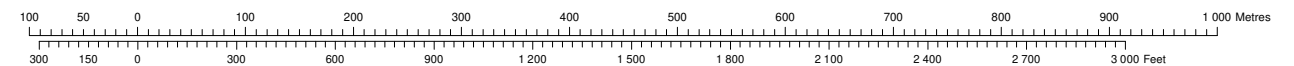

Changes: Parking Positions 1,3,5,7 Changed.

PAGE INTENTIONALLY LEFT BLANK